

SURFACE PREPARATION

The surface should be dry, clean and free from dirt, grease, algal and fungal growth. New plastered surfaces should be allowed to cure for at least 28 days. Surface imperfection should be removed with the use of Acro POLYPLASTER as per directions.



COVERAGE

Approx. 2.8-3.4 sq. ft./ kg. per coat depending on the texture and porosity of the surface.

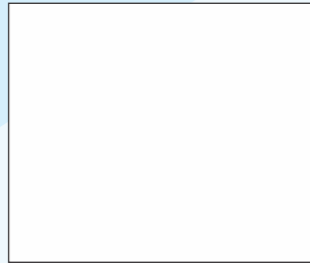

PACKING

Available in 25 Kg & 30 Kg packing.



THINNER

Can be thinned with 3-4 % potable water as per requirement.

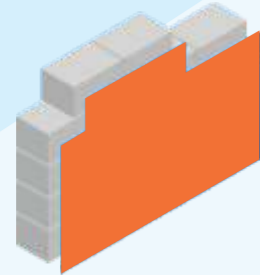

COLOUR AVAILABILITY

As per natural stone availability.

PRECAUTION



- a) Avoid application in temperatures over 40°C and below 5°C and in strong winds. Wash all application equipments with water immediately after use.

JK Cement Ltd.

Kamla Tower, Kanpur, UP - 208001

Toll-free Number: 1800 203 4555 | Website: www.jkmaxxpaints.com

Email Address: consumercare@jkmaxxpaints.com



JK MAXIMO Patternz **RockTex**

SANDYSTONE



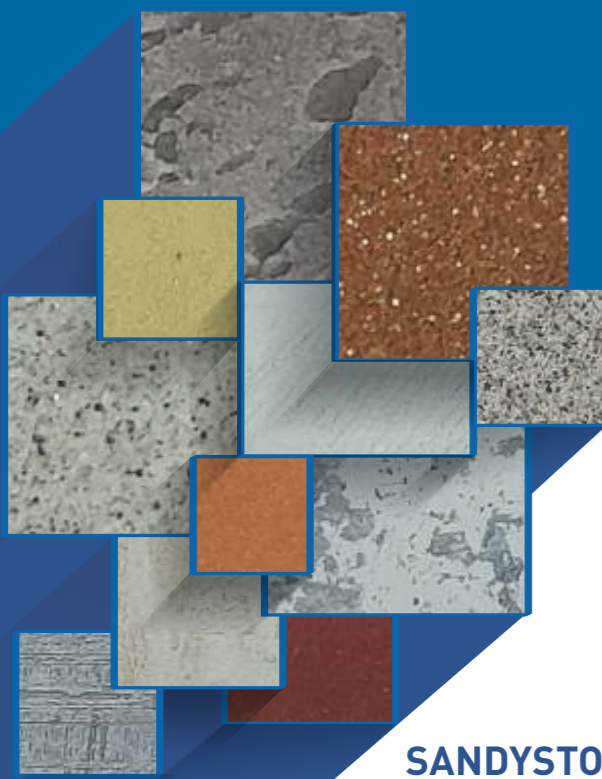

JK MAXIMO
Patternz RockTex

SANDYSTONE
ACRYLIC AGGREGATE TEXTURED WALL FINISH

SANDYSTONE is a non tinted granular textured wall finish for the protection and decoration in the exteriors and interiors.



APPLICATION AREA

Exteriors and interior of cement sand plasters, Stucco, Concrete, Gypsum Boards, Bricks, Wood, etc.

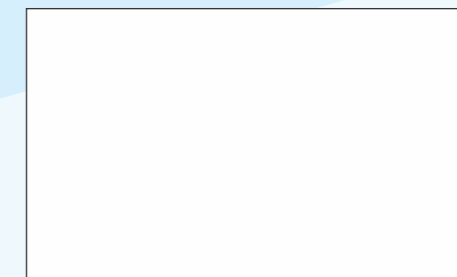

FINISH

High build granular acrylic aggregate textured (semi rough starry finish) wall coating in pigmented finish by S.S. trowel & finished with Polystyrene trowel.



DRYING TIME

Hard Dry : 8 hours.



TECHNICAL DATA

PRODUCT BENEFITS/FEATURES



Algae & Fungus Resistance



Good flexibility and adhesion



Alkali Resistant



Bridges Hairline Cracks



Value for Money



UV Resistance

APPLICATION

- a) Acro POLYUNDER coat as Sealer / Primer of required shade.
- b) Apply the 1st coat of SANDYSTONE of required shade by the trowel as smooth plaster and make the desired grooved pattern with the help of trowel in 2nd coat..

